

# CIVIC THEATRE

## TECHNICAL SERVICES INVENTORY CIVIC THEATRE - MAIN AUDITORIUM

<i>Contents</i>	<i>Page</i>
<b>Seating Capacity</b>	<b>2</b>
<b>Dress Circle Seating Plan</b>	<b>2</b>
<b>Stalls Seating Plan</b>	<b>3</b>
<b>Vertical Stage Plan</b>	<b>4</b>
<b>Horizontal Stage Plan</b>	<b>5</b>
<b>Stage Dimensions</b>	<b>7</b>
<b>Rigging / Fly System</b>	<b>7</b>
<b>Orchestra Catwalk Truss</b>	<b>7</b>
<b>Auditorium Side View (Elevation) Plan</b>	<b>9</b>
<b>Hanging Plot</b>	<b>10</b>
<b>Stage Apron (Thrust) / Draperies</b>	<b>11</b>
<b>Power / Dimmers</b>	<b>12</b>
<b>Lighting Control Desk / Equipment / Data Distribution</b>	<b>13</b>
<b>Lighting Position / Dimmer / Circuits</b>	<b>14</b>
<b>Sound Desk / Equipment</b>	<b>15</b>
<b>UHF Wireless Microphones</b>	<b>17</b>
<b>Stage Management / Communications</b>	<b>19</b>
<b>Cue Light System / Closed Circuit Television / Cameras</b>	<b>20</b>
<b>Dressing Rooms</b>	<b>20</b>
<b>Mezzanine / Green Room / Production office / Orchestra Pit</b>	<b>21</b>
<b>Loading Facilities</b>	<b>21</b>
<b>Pianos / Treads / Risers / Ladders / Chairs / Bar Stools / Music Stands</b>	<b>22</b>

## SEATING CAPACITY

**Full Lyric Mode** Capacity: 1,502  
Theatre Capacity 1,508  
Less wheelchair MNO 29,30 6  
**Total** 1,502

**Orchestral Mode** Capacity: 1,467  
Theatre Capacity 1,502  
Less: Stalls Rows A - B 35  
**Total** 1,467

**Reduced Lyric Mode** Capacity: 1054  
Theatre Capacity 1,502  
Less: Stalls Rows P - Y 440  
Less: Boxes 8  
**Total** 1054

**Intimate Lyric Mode** Capacity: 439  
Theatre Capacity 1,502  
Less: Stalls Rows P - Y 440  
Less: Boxes 8  
Less: All Dress Circle 615  
**Total** 439

**Stalls only** Capacity: 879

The following seats may be removed for production purposes/sound positions from any of the modes above

**Sound Mix Position # 1 - Centre of Stalls**  
(Stalls, O 19-28, P 19 - 26) 16

**Sound Mix Position # 2 - Rear of Stalls**  
(Stalls X 19-27, Y 19-27) 18

## DRESS CIRCLE

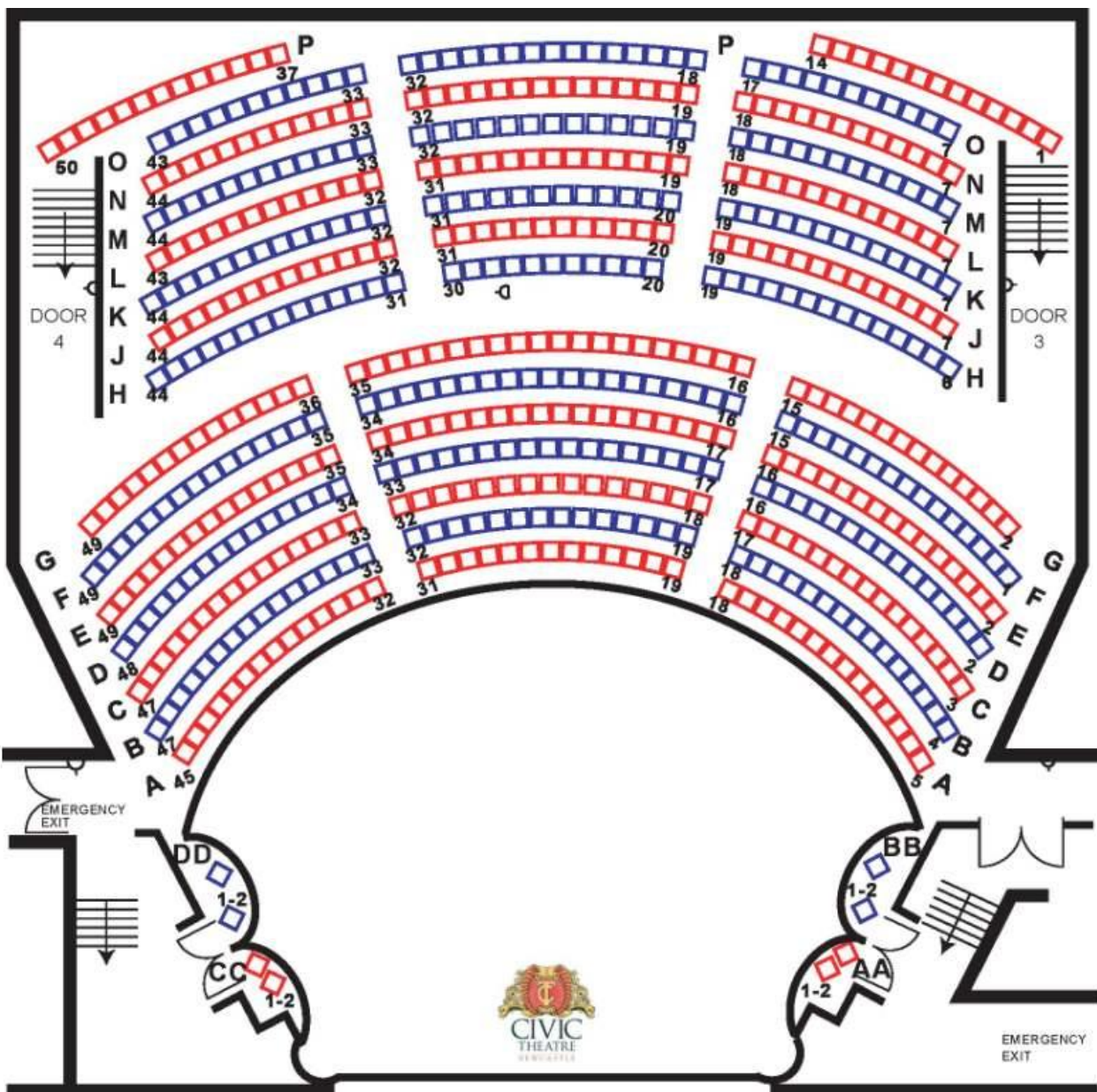



## STALLS

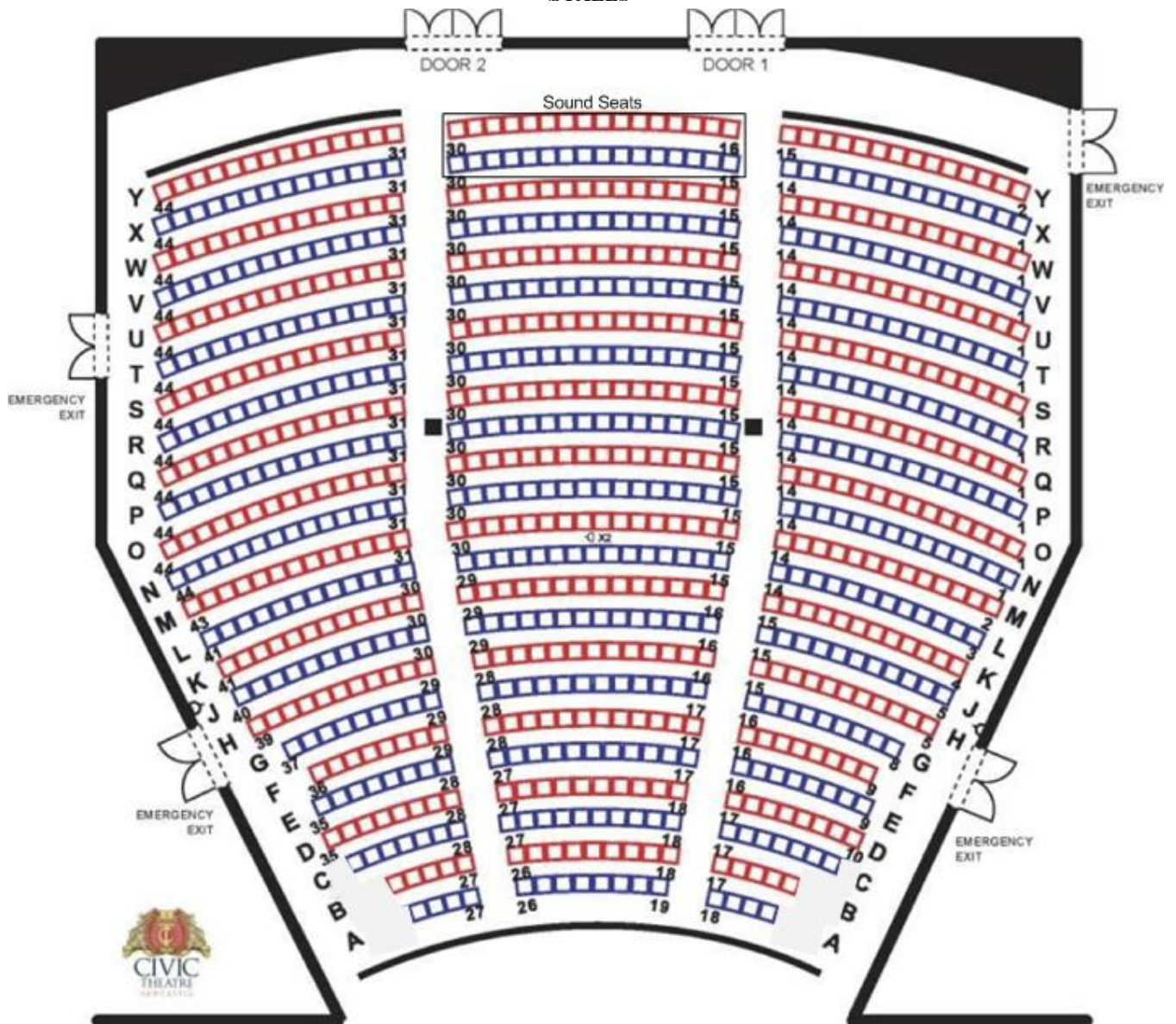

VERTICAL STAGE DIMENSIONS

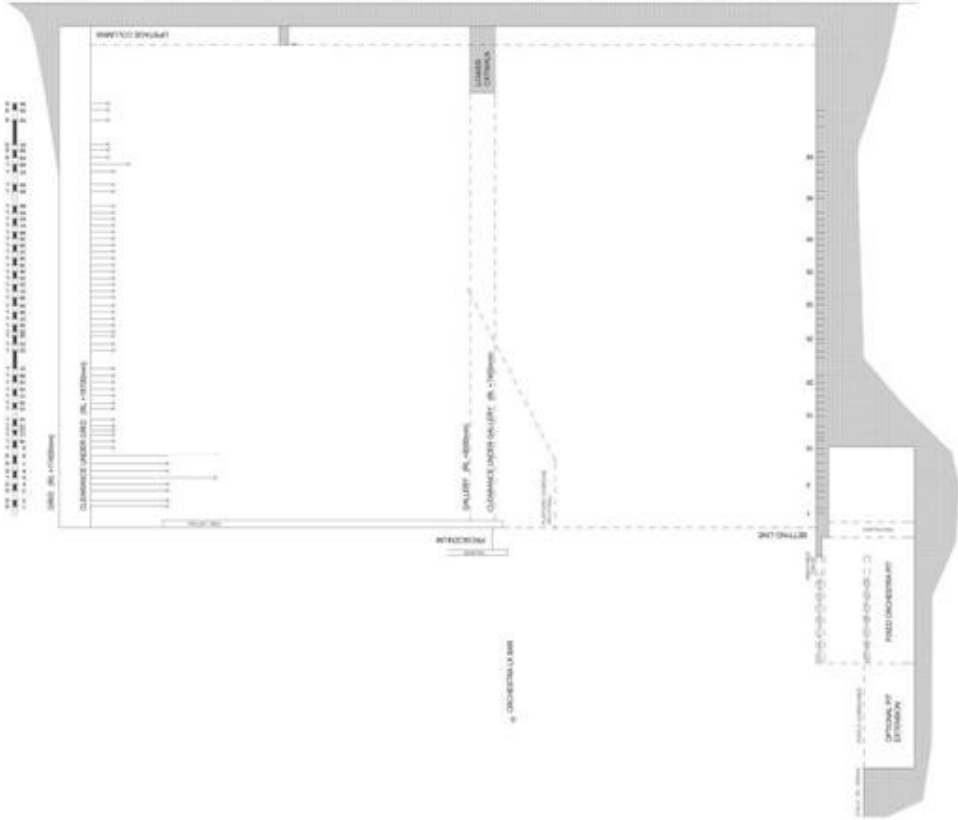
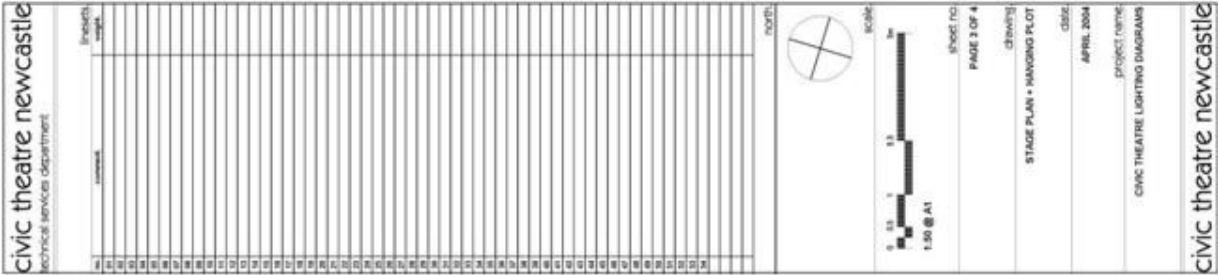

## HORIZONTAL STAGE DIMENSIONS

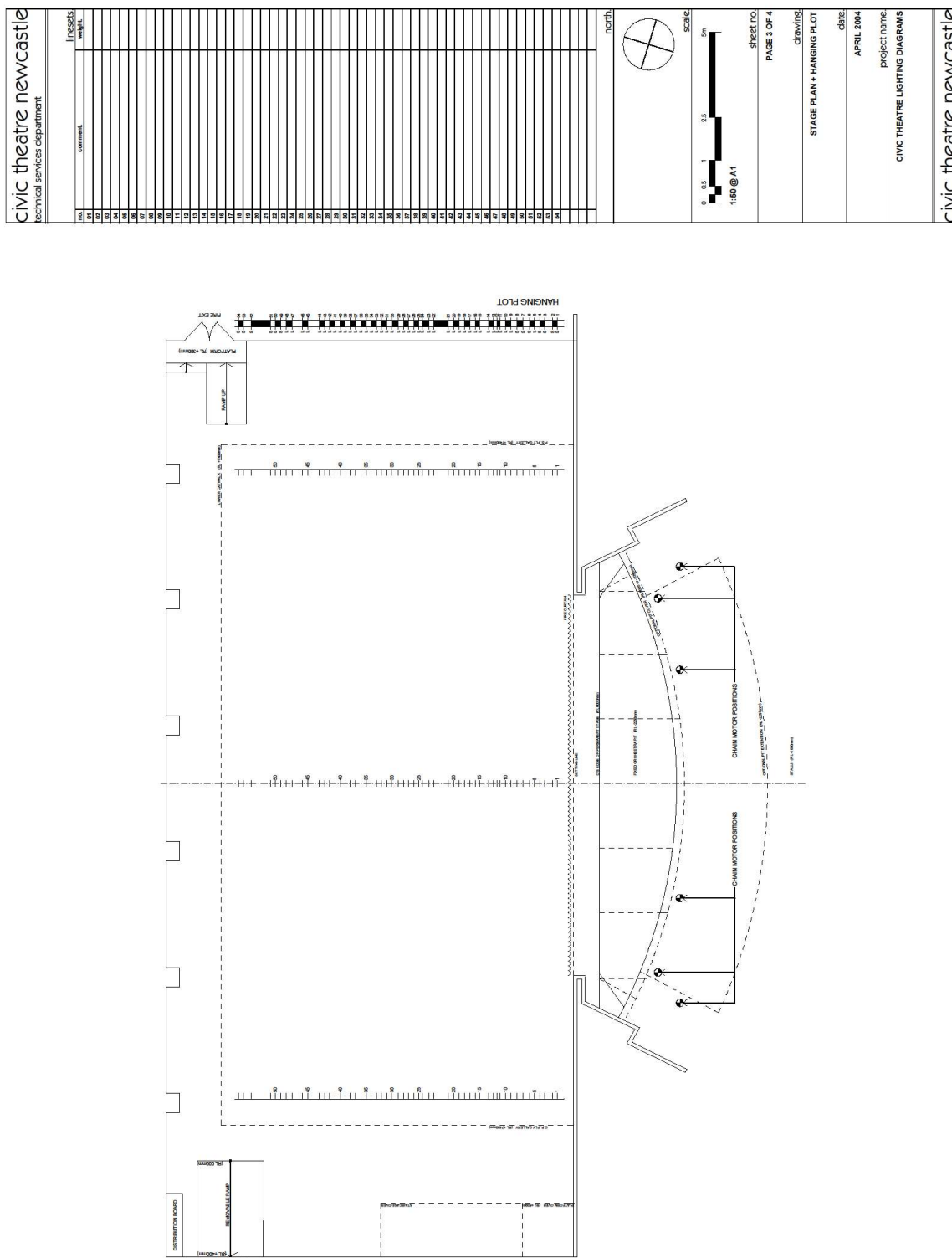





## STAGE DIMENSIONS

### Proscenium

Width	11000mm
Minimum width	10820mm
Height of Proscenium Opening	7500mm
Height to bottom of Fire Curtain	7250mm
Height to bottom of fixed Front	
Valance/Main Drape	7050mm

### Stage Depth

Setting line:

- to D.S. edge of stage	685mm
- to Last Line	9790mm
- to Back wall Columns (4 of)	11140mm
- to Back wall	11500mm
- to D.S. edge of thrust at centre line	3060mm
- D.S. edge of Thrust Radius (approx)	14500mm
- Front of thrust arc width	13400mm

### Stage Width

O.P wall to fly locking rail	26000mm
------------------------------	---------

### Fire Curtain

Steel Drop directly upstage of Pros. / Setting line

Depth of curtain 160mm

Must remain unobstructed / **must be dropped nightly**

### Grid / Fly Tower

Height to the underside of Grid	17380mm
Height to the underside of Fly Galleries	7400mm
Distance between Galleries	19400mm
Height to the underside of U.S catwalk	9060mm
Setting line to the D.S edge of catwalk	10000mm

### Stage Surface

Flat / sprung floor on timber rafters / joists

Masonite on plywood.

Distribution Load (Aust. Standard Approved) 7.5KPA

Concentrated Load (Aust. Standard Approved) 4.5KN

Painted flat black

### Stage Entry Door / Prompt Fire Egress:

- located U.S. Prompt / must remain unobstructed
- height 2060mm
- width 1620mm
- 2 steps down to stage

### Stage Loading dock door / OP Fire Egress

- Upstage OP / stage right. 1800mm movable Ramp from lane outside 450mm down to stage level
- Door Max opening 2120mm width x 3000mm high, with extra door above to max height of 5300mm

## RIGGING / FLY SYSTEM

### Fly System

Single purchase counterweight system

Operated from stage level PS.

54 Line Sets

### 45 Long Cradles

- Maximum Drift	16 250mm
- Maximum Capacity	400kg

### 9 x short Cradles

Maximum Drift	15000mm DS / 16500 US
Max capacity	300kg / 400kg with slave

### Head Battens

All battens are RHS	50mm x 100mm
Length of barrels	18000mm
5 x 6mm FSWR pick ups	
Pick up points	Centre, 3700mm, 8000mm

### Electric Spot Bars

4 x pre wired LX bars (length)	15000mm
1 x pre wired LX cyc bar (length)	15000mm

### Side Lighting Ladders

8 x units (4 per side)

Tracked from under O.P. / Prompt Galleries

Length of track from D.S setting line to U.S. 8,500mm

Distance from stage to Top lamp 7,000mm

Distance from stage to Bottom lamp 4,700mm

### Flown sound rigging points 2 @ 1000kg

Distance from centre to audio points	5430mm
Horizontal distance from setting line	2400mm

**Note: flown PA sits below catwalk truss**

### Orchestra Pit LX Bar 2 x points @ 1000kg

Catwalk truss (length)	11000mm
Min. vertical distance bottom catwalk to stage	7,000mm
Minimum vertical distance barrel to stage	7,900mm
Horizontal distance from setting line	3000mm
Distance from centre to pick ups	3375mm
2 x Prolyft chain motors rated at 1000kg each	
Vertical to stage	9000mm

**NB. Moving lights cannot direct its beam from the cantilevered lighting bar on the truss back into the auditorium. Under slung pipe can be rigged which enables this. Truss will not be de-rigged from standard without prior arrangement.**





## AUDITORIUM SIDE VIEW (ELEVATION)

CTN CLIENT KIT:  
TECHNICAL SERVICES INVENTORY (PLEASE RETAIN)

### CIVIC THEATRE NEWCASTLE AUDITORIUM SIDE VIEW

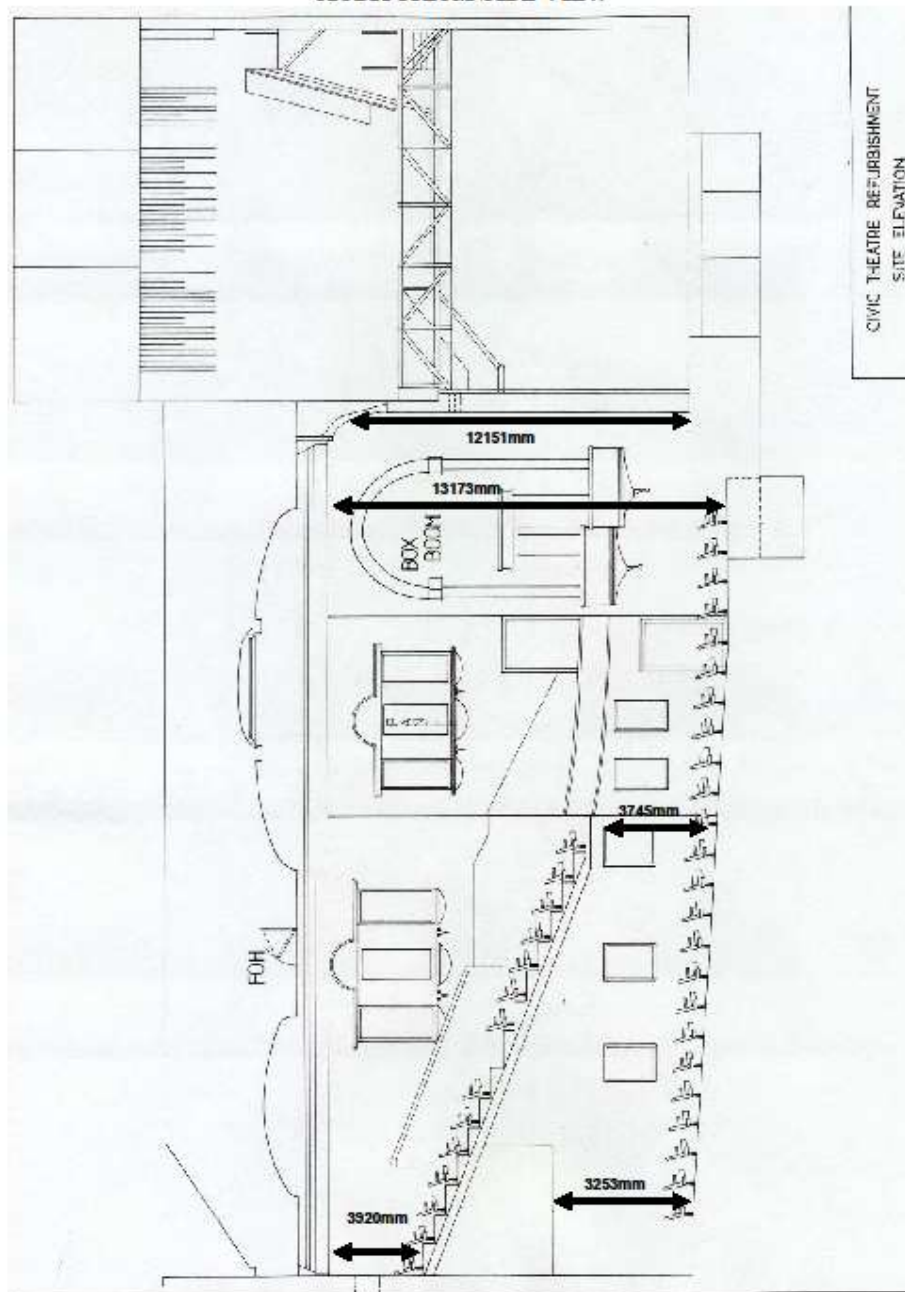

D:\WORK\FILE\GEN\B\GMT\CLIENT\PA\CTN\PACK\SPEC\VIC.DOC

As at 1 January 2000

**HANGING PLOT STANDARD RIG**

Line No.	Distance From Set Line	Between Bars (mm)	Cradle Size	Drift In (metres)	Drift Out (metres)	Item Description	Standard Trim (metres)	Kilos to Balance Bar	Weights
<b>0</b>									
<b>1</b>	325	325	M	3.5	14.65	<b>House Curtain</b>	<b>Tab or Fly</b>	247	24 half std
<b>2</b>	675	350	S	1.2	15.00	<b>Border</b>	5800	66.5	8 std
<b>3</b>	790	115	S	1.2	15.00	<b>Legs</b>	5250C/L	38	5 std
<b>4</b>	950	160	S	1.2	15.00				
<b>5</b>	1100	150	L	1.2	13.9	<b>LX 1</b>	7200	374	10 / 22
<b>6</b>	1260	160	S	1.2	15.00				
<b>7</b>	1425	145	S	1.2	15.00				
<b>8</b>	1575	150	S	1.2	15.00				
<b>9</b>	1745	170	L	1.2	16.250				
<b>10</b>	1890	145	L	1.2	16.250				
<b>11</b>	2050	160	L	1.2	16.250				
<b>12</b>	2200	150	L	1.2	16.250				
<b>13</b>	2355	155	L	1.2	16.250	<b>Border</b>	6000	66.5	8 std
<b>14</b>	2510	155	L	1.2	16.250	<b>Legs</b>	5250 C/L	38	5 std
<b>15</b>	2660	150	L	1.2	16.250				
<b>16</b>	2825	165	L	1.2	16.250				
<b>17</b>	2970	145	L	1.2	16.250	<b>LX 2</b>	7400	385	10 / 25
<b>18</b>	3130	160	L	1.2	16.250				
<b>19</b>	3285	155	L	1.2	16.250				
<b>20</b>	3445	160	L	1.2	16.250				
<b>21</b>	3575	135	L	1.2	16.250				
<b>22</b>	3965	390	L	1.2	16.250	<b>Border</b>	6200	66.5	8 std
<b>23</b>	4110	145	L	1.2	16.250	<b>Legs</b>	5250 C/L	38	5 std
<b>24</b>	4260	150	L	1.2	16.250				
<b>25</b>	4455	195	L	1.2	16.250	<b>LX 3</b>	7400	385	10 / 22
<b>26</b>	4620	165	L	1.2	16.250				
<b>27</b>	4770	150	L	1.2	16.250				
<b>28</b>	4925	155	L	1.2	16.250	<b>Black Tabs (tab track)</b>		134	16 std
<b>29</b>	5080	155	L	1.2	16.250				
<b>30</b>	5225	145	L	1.2	16.250				
<b>31</b>	5380	155	L	1.2	16.250				
<b>32</b>	5535	155	L	1.2	16.250				
<b>33</b>	5695	160	L	1.2	15.9	<b>Border</b>	6400	66.5	8 std
<b>34</b>	5850	155	L	1.2	16.250	<b>Legs</b>	5250 C/L	38	5 std
<b>35</b>	5995	145	L	1.2	16.250				
<b>36</b>	6160	165	L	1.2	16.250				
<b>37</b>	6315	155	L	1.2	16.250	<b>LX 4</b>	7600	385	10 / 25
<b>38</b>	6465	150	L	1.2	16.250				
<b>39</b>	6610	145	L	1.2	15.9				
<b>40</b>	6775	165	L	1.2	16.250				
<b>41</b>	6930	155	L	1.2	16.250				
<b>42</b>	7090	160	L	1.2	16.250	<b>Black Scrim</b>		23	2 std
<b>43</b>	7225	135	L	1.2	16.250	<b>Border</b>	6600	66.5	8 std
<b>44</b>	7345	120	L	1.2	16.250	<b>Legs</b>	5250 C/L	38	5 std
<b>45</b>	7720	375	L	1.2	16.250	<b>LX 5 (cyc)</b>	7600	418	10 / 13
<b>46</b>	7865	145	L	1.2	16.250				
<b>47</b>	8145	280	L	1.2	16.250				
<b>48</b>	8310	165	L	1.2	15.9				
<b>49</b>	8470	160	M	1.2	16.50				
<b>50</b>	8620	150	M	1.2	16.50				
<b>51</b>	8780	160	M	1.2	16.50				
<b>52</b>	9430	650	S	1.2	16.50				
<b>53</b>	9590	160	S	1.2	16.50	<b>Cyclorama cloth</b>		47.5	5 std
<b>54</b>	9790	200	S	1.2	16.50	<b>Black Backing</b>		95	11 std

### **PIT EXTENSION / THRUST**

#### **8 - Independent sections with 4 levels each**

Plywood / masonite / steel construction

- 1- stage level 00mm below stage level
- 2- stalls level 1,050mm below stage level
- 3- riser level 1,950mm below stage level
- 4- fixed pit 2,250mm below stage level

### **DRAPERIES**

#### **Main Curtain**

**1 unit** - 14,000mm x 8,000mm

Positioned on line set #1 **Must be used on line # 1**

- Red
- Guillotine action; Manually operated from prompt
- And Tab Action; Motor driven Variable Speed
- Split at Centre

#### **Sets of Blacks # 1**

##### **5 sets**

5 x borders 18,000mm x 4,000mm  
10 x legs 4,500 mm x 8,000mm

#### **Black Tabs - (split at centre)**

**1 unit** - 18,000mm x 8,000mm

**1 unit** - 17,000mm x 8,000mm on Tab Track

#### **White Cyc**

**1 unit** 18,000mm x 7,500mm

#### **Old House Curtain – Red Velvet**

**1 Unit** – 14,000mm x 8,000 mm

#### **Black Scrim**

**1 unit** 18,000mm x 7,000mm

**Various other cloths available upon enquiry**

## POWER / DIMMERS

### *Distribution*

#### **OP U/S wing**

**100 amps** per phase outlet with a distribution board

2 x 32 amp 3 phase 5 pin wilco

4 x 20 amp single phase 3 pin large earth pin

4 x 10 amp double GPO

#### **Dimmers Portable**

Bytesize Dimmers version 8.13 **Total 48** 48 x 2.4Kw

DMX 512 Protocol

#### **Powerlock**

**200 amps** per phase

**US OP.**

#### **Dimmers Fixed**

Bytesize Dimmers version 8.13 **Total 300** 228 x 2.4 Kw

DMX 512 Protocol 72 x 5.0 Kw

#### **PS D/S wing**

**100 amps** per phase; **Powerlock** connection 10 metres up on gallery level, with a **distribution board** at stage level -

2 x 32 amp 3 phase 5 pin wilco

4 x 20 amp single phase 3 pin large earth pin

4 x 10 amp double GPO

#### **Orchestra Dimmer**

**Total 2**

2 x 5.0 Kw

Controlled from Stage Manager Console

Auxiliary control PS of pit

#### **DS OP (Audio power)**

**30 amps** 5 pin Wilco outlet with a distribution board

1 x 20 amp 5 pin wilco

3 x 10 amp double GPO

## **HOUSE LIGHTS**

Controlled from Bio Box from 8 preset controller with variable presets, auxiliary controls at Stage Managers Console PS, FOH trap + FOH in main foyer.

### **STANDARD HOUSE LIGHT PRESETS**

Preset 1	-	House Lights	100%
Preset 2	-	House Lights	75%
Preset 3	-	House Lights	50%
Preset 4	-	House Lights	25%
Preset 5	-	House Lights full – no arch	
Preset 6	-	Custom Preset	
Preset 7	-	Custom Preset	
Preset 8	-	House Lights out	



## LIGHTING

### Control Desks

(NB: CTN venue hire only includes one console,  
please confirm console selection with Technical Manager)

ETC GIO console, 2048 channels,  
2 x touch screens  
1 x fader wing with 40 submasters

ETC Ion xe console 4524 channels  
2 x Dell 23" touch screens  
1 x fader wing with 40 submasters

1 x wireless focus remote using Ipad

### Data Distribution

2 x Jands DD8 splitters  
3 x Pathport 8-way optical DMX splitters - RDM supported  
2 x ETC Net3 Gateways  
1 x PoE Network switch (sACN network)

### Data Codes

Protocol DMX 512 / sACN

### DMX Distribution (star from dimmer room)

**Inputs** Bio Box, Stalls, Gallery OP., Gallery PS, Stage OP, Stage PS, Row N Stalls, Dress Circle

**Outputs** Gallery OP, Gallery PS, Stage OP, Stage PS, Row N Stalls, Dress Circle

Bio Box, Lx1, Lx2, Lx3, Lx4, FOH Truss, Ladder positions, Onstage Dip-traps

### Cat6 Distribution (star from dimmer room)

Bio Box, Stalls, Gallery OP., Gallery PS, Stage OP, Stage PS, Row N Stalls, FOH Truss

### Lamp Stock

30 x	ETC D60Lustre+ LED Wash fixtures
12 x	Martin MAC Aura LED wash fixtures
10 x	Altman Spectra Cyc-200 LED fixtures
46 x 1.2Kw	12/28 Selecon Pacific 80v ("M") <b>Not to be moved from FOH position.</b>
20 x	ETC Source-4 LED 2 (10@19° 10@26°) <b>Not to be moved from ladder position.</b>
30 x 1.2Kw	16/32 Selecon Zoom profile with gobo holder ("B")
70 x 1.0 Kw	14/35 Pacific Selecon ("B")
2 x 1.0 Kw	45/75 Pacific Selecon Profile ("B")
24 x 2.0Kw	Alto fresnels
32 x 1.2Kw	Selecon fresnel with barndoors
48 x 1.2Kw	Selecon Rama fresnel with Barndoors
50 x 1.0Kw	Kupo 240volt Par Cans
1 x 3.0Kw	Martin Atomic 3000 DMX Strobe
1 x 2.0Kw	Geni FL1800D Dmx Golden Strobe
4 x 50w	3cts Mini strips under 2Kw per circuit

### Follow Spots

2 x 2.5Kw Xenon Ushio Supersol

### Accessories

2 x Winch Up Floor stands 18'  
10m Aluminium Tri truss  
10 x 3.3m booms / wheel bases  
4 x T stands, push up  
55 x Boom arms  
8 x Boom Base  
All lamps are complete with gel frames  
Multi cable / 4cct Wieland, looms, singles

**LIGHTING POSITIONS/DIMMER CIRCUITS**

Lighting Position	No. Of Outlets	Dimmer No	No. Of Dimmers	Capacity	
<b>F.O.H.:</b>					
Main Slot	18	1 - 18	12 x	2.4Kw	
			6 x	5Kw	
PS Star	3	19 - 21	3 x	2.4Kw	
OP Star	3	22 - 24	3 x	2.4Kw	
<b>Box Boom:</b>					
PS Panel	6	25 - 30	6 x	2.4Kw	
OP Panel	6	31 - 36	6 x	2.4Kw	
PS Box Boom	6	37 - 42	6 x	2.4Kw	
OP Box Boom	6	43 - 48	6 x	2.4Kw	
<b>Circle Front</b>	12	49 - 60	12 x	2.4Kw	
<b>Orchestra Bar</b>	30	61 - 90	30 x	2.4Kw	
<b>Footlights</b>	6	91 - 96	6 x	2.4Kw	
<b>L X Bar 1</b>	24	97 - 108	18 x	2.4Kw	37 patches
		109 - 120	6 x	5.0Kw	
<b>L X Bar 2</b>	24	121 - 132	12 x	2.4Kw	37 patches
		133 - 144	12 x	5.0Kw	
<b>L X Bar 3</b>	24	145 - 156	12 x	2.4Kw	37 patches
		157 - 168	12 x	5.0Kw	
<b>L X Bar 4</b>	24	169 - 180	12 x	2.4Kw	37 patches
		181 - 192	12 x	5.0Kw	
<b>L X Bar 5 (Cyc)</b>	24	193 - 204	12 x	2.4Kw	4 groups of 4 patches + 22 patches
		205 - 216	12 x	5.0Kw	
<b>Prompt Fly Gallery</b>					
D/S	6	229 - 234	6 x	2.4Kw	
M/S	6	235 - 240	6 x	2.4Kw	
U/S	6	241 - 246	6 x	2.4Kw	
Back	6	247 - 252	6 x	2.4Kw	
<b>O.P. Fly Gallery</b>					
D/S	6	253 - 258	6 x	2.4Kw	
M/S	6	259 - 264	6 x	2.4Kw	
U/S	6	265 - 270	6 x	2.4Kw	
Back	6	271 - 276	6 x	2.4Kw	
<b>PS - Floor Traps</b>					
D/S	6	277 - 282	6 x	2.4Kw	
M/S	6	277 - 279	3 x	2.4Kw	3 patches from D/S
		283 - 285	3 x	2.4Kw	
U/S	6	277 - 279	3 x	2.4Kw	3 patches from D/S
		286 - 288	3 x	2.4Kw	
G/R	6	217 - 222	6 x	5.0Kw	
<b>OP - Floor Traps</b>					
D/S	6	289 - 294	6 x	2.4Kw	
M/S	6	289 - 291	3 x	2.4Kw	3 patches from D/S
		295 - 297	3 x	2.4Kw	
U/S	6	289 - 291	3 x	2.4Kw	3 patches from D/S
		298 - 300	3 x	2.4Kw	
G/R	6	223 - 228	6 x	5.0Kw	

## SOUND

### Power

1 x 40 amp 3 phase (5 pin wilco) / Located DS OP / Separate Earth

### Consoles/ Racks / Control Processor

(NB: CTN venue hire only guarantees access to one console,  
please confirm console selection with Technical Manager)

1 x DiGiCo SD12 with 72 Input Channels, 36 Aux / Sub-Group Busses

1 x DiGiCo SD9 Stealth Core 2 with 96 Input Channels, 48 Aux / Sub-Group Busses

1 x DiGiCo D2 Rack MADI I/O 48 inputs, 24 outputs

1 x DiGiCo D-Rack, 32 in, 8 analogue out, 4 AES out

1 x DiGiCo D-Rack, 32 in, 16 analogue out

DiGiCo LRB & LBB bnc/cat5 split/conversion

1 x Meyer Galileo GALAXY 816-AES3 with Compass control option

1 x Meyer Galileo 616 with Compass control option

### Speakers Meyer equipment available at additional cost (As per Contract )

4 x Meyer UPQ-D1 (Main PA)

*Supplementary Stock*

2 x Meyer UPJ-1P (In fill)

6 x Meyer UPA-1P speakers

4 x Meyer 900-LFC (Subs)

2 x Meyer UPA-2P speakers

4 x Meyer UPM-1P (under balcony fill)

2 x Meyer USW-1P Sub speakers

4 x Meyer UPM-1P (front/lip fill)

2 x Meyer USM-100P (15" wedges)

4 x NEXO PS10 speakers + analogue TD controller (2 x stereo Yamaha P7000 amplifiers)

4 x NEXO PS15 speakers + digital TDT controller (2 x CAMCO D-Power4 amplifiers)

### Playback

1 x Denon DN 635 Compact Disc player

1 x Denon DN-T625 CD/ Tape

### Recording

1 x Tascam RS-200 digital 2 track recorder (SD card/compact flash/usb)

### Microphones

8 x Shure SM 58

2 x AKG C568EB (Mini Shotgun)

6 x Shure BETA 58

2 x Rhode NTG-2 (Shotgun)

6 x Shure SM 57

4 x Rhode NT5

1 x Shure BETA 57

2 x CAD 95

1 x Shure BETA 52A

4 x Crown PCC 160 (Boundary)

1 x Beyerdynamic M-88TG

2 x AKG C680 (Boundary Layer)

1 x Sennheiser e901

4 x DPA 4098H (Super Cardioid Hanging)

5 x Sennheiser e904

2 x DPA SC4098 (Super Cardioid Lectern)

4 x Sennheiser e906

1 x Shure MX 412s (Super Cardioid Lectern)

2 x Sennheiser e908B clip on

1 x Shure SM99 (Cardioid Lectern)

4 x AKG C535EB

5 x LA Audio DI 2 mk3 active DI

2 x AKG C480

4 x Radial J48 active DI

2 x AKG CK391

2 x Radial JPC stereo PC DI active outputs

### **Microphone Stands**

9 x Beyerdynamic Short Boom Stands  
12 x Beyerdynamic Boom Stands  
8 x Beyerdynamic Straight Stands (tripod base)  
3 x Chrome round base straight stands  
1 x Black round base straight stand

### **Patching**

40 + 12 lines in the Auditorium: 1 x Set at the Rear / Centre of the Stalls  
40 + 12 x lines in the Control Room  
104 Tie Lines around Stage and Pit  
Main patch bay in the D.S.O.P Area  
All XLR plugs are Pin 2 Hot

### **Cat 6e double shielded ethercon for DiGiCo SD9/SD12**

2 x Rear stalls, 2 x Mid stalls, 2 x Orchestra pit, 2 x Dress circle, 2 x Upstage centre, 2 x Downstage prompt trap. All cables run to patch bay downstage OP with audio patch bay.

### **Cores and stage drop boxes**

1 x 12 way 15m  
4 x 8 way 15m  
1 x 4way 10m

### **Multi cable runs**

Multi cables run from downstage prompt orchestra pit to rear of stalls via 150mm PVC pipe. Approx. 50m from stage wings to FOH via PVC pipe.

Cable Run Measurements from setting line

To Centre of Stalls	Sound mix position # 1	25,000 mm
To Rear of Stalls	Sound mix position # 2	45,000 mm

### **Flown sound rigging points 2 @ 1000kg**

Distance from centre to audio points 5430mm  
Horizontal distance from setting line 2400mm

**Note; flown sound sits below catwalk truss**, bottom of truss at 7000mm above stage, (8050mm above auditorium floor) at standard, 8500mm above stage at high dead. Flown PA will cause some sight line issues.

Ground stacks/ subs will cause some sight line issues



## UHF Wireless Microphones

The Civic Theatre has 16 UHF Microphone Systems. These are Sennheiser Evolution G3 100 series. All systems are 626-668MHz, Sennheiser Group B. They are divided into 2 racks of 8 systems. Each system is charged as per contract rates and charges.

These 16 systems include:-



- Receiver Unit (sennheiser EM100 G3)
- Power supply (sennheiser power distribution 12vdc 410mA)
- Handheld Microphone (16 x Dynamic = SKM 845 optional 2 x MMD 945 capsules)
- Beltpack transmitter (16)
- Lapel Microphone (6 x AKG C417 III TL Omnidirectional)  
(16 x Sennheiser ME 2 Omnidirectional)

\*NB. Only 1 of the microphones within each system may be used at any one time (ie. handheld **or** lapel/head worn)



16 x DPA 4066 adjustable head worn microphone available at an additional cost.

**The systems are pre-tuned and divided, as follows;**

Civic 1	626.475MHz	<i>There are also 6 x Sennheiser EW100 G3 wireless systems used in the City Hall, which is part of the Civic Precinct. They are pre-tuned as follows:</i>	
Civic 2	627.100MHz		
Civic 3	628.150MHz		
Civic 4	629.625MHz	Banquet room	653.000MHz
Civic 5	631.300MHz	Cummings room	656.450MHz
Civic 6	631.650MHz	Hunter room	658.250MHz
Civic 7	633.975MHz	Fort Scratchley	661.250MHz
Civic 8	634.725MHz	Concert Hall #1	662.300MHz
Civic 9	635.825MHz	Concert Hall #2	663.050MHz
Civic 10	638.500MHz	<i>Another 4 x Sennheiser EW500 G4 wireless systems are also used in City Hall and are pre-tuned as follows;</i>	
Civic 11	639.075MHz		
Civic 12	641.725MHz		
Civic 13	643.200MHz	City Hall G4 Rack 1	
Civic 14	647.125MHz	City Hall G4 Rack 2	
Civic 15	649.300MHz	City Hall G4 Rack 3	
Civic 16	649.700MHz	City Hall G4 Rack 4	

## **SUMMARY**

There are a total of 16 wireless systems, which can use any combination of the mic's listed below.  
(Handheld **or** Lapel / DPA headset)

There are 16 handheld mic's (Sennheiser SKM 845)

There are 16 lapel style clip on mic's (Sennheiser ME 2)

There are 16 headworn mic's (DPA 4066F omnidirectional)

There are 6 lapel style clip on mic's (AKG C417 III TL – omnidirectional)

There are 4 Plug on transmitters for use on any dynamic/condenser microphone (+48v XLR)

There are 2 interchangeable capsules (Sennheiser MMD 945 for the SKM 845)

## **STAGE MANAGER CONSOLE**

### **Location**

Located D.S. Prompt

This is a touch screen system with paging to all dressing rooms and foyers, and talkback

## **TALKBACK**

Talkback System Jands E400 EasyCom. System

Master station at S.M. console D.S. Prompt

4 Loop Talkback with 34 Outlets

4 Way 20 line matrix switcher

Headsets            8 Beyer DT 108 Single can,      4 Beyer DT 280

                         9 Beyer DT 109 Double cans,    6 Beyer DT 290

                         10 Beltpacks - Jands E100

(not including ops positions – SMC / FLY's / FOH audio / BIO BOX LX / Domes)

## **WIRELESS COMMS**

1 x CM-222 Clear-com 'Tempest' 2.4GHz 2 channel wireless intercom master station

2 x CP-222 Clear-com 'Tempest' 2.4GHz dual listen wireless beltpacks

4 x Re-chargeable lithium polymer battery packs + charger dock

## CAMERAS

2 x Face of the Dress Circle on the Centreline - 1 x lowlight, 1 x normal exposure switchable at SM console

1 portable MD / monitor CAM

## DRESSING ROOMS

All come with full ensuite facilities, air conditioning / heating, paging and program relay audio.

Number of performers are based on maximum mirror positions

Dress #	Level	No. of Perf.	Location
1	Stage level	4	U/S
2	Stage level	4	D/S
3	Stage level	4	D/S
4	1st Floor	12	U/S - Stair well end
5	1st Floor	5	
6	1st Floor	5	
7	1st Floor	4	
8	2nd Floor	12	U/S - Stair well end
9	2nd Floor	8	
10	2nd Floor	8	
11	2nd Floor	3	
TOTAL		69	

## Mezzanine

Above crossover directly behind main stage

Can be reconfigured depending on production. Hard floor, air conditioning.

Preferred room for makeup / body paint application.

## ORCHESTRA ASSEMBLY ROOM

Located Prompt at Orchestra pit level

Air Conditioned / heated

Wall mirrors

Complete with tables / chairs / wardrobe racks

Suitable for max twenty (20) persons

## GREEN ROOM

Located third level dressing room / Promenade level

Paging and program sound

Stage monitor / Television

Tea making facilities

Small refrigerator

Chairs

## LAUNDRY

2 x Washing Machines

4 x Tumble Dryers

1 x Steam Iron

1 x Ironing Board

1 x Emergency sewing box

4 x Portable Wardrobe Racks

## PRODUCTION OFFICE

Located in stage door corridor

1 x Fridge

1 x Freezer

1 x Microwave



Internet

### TRAP ROOM

Located directly upstage of Orchestra pit		<b>No Traps</b>
Height of room	2,050mm/1750mm	Poured concrete floor
Depth U.S. from setting line	3,000mm	Access from Prompt
Width although varies	12,000mm	Used as storage for auditorium seats / Civic lamps

### ORCHESTRA PIT

#### Small pit

Rear wall to centre D.S. edge	4,900mm
Rear wall to P.S. downstage edge	4,150mm
Maximum width	9,400mm
Depth below stage	2,250mm

#### Large pit

Rear wall to centre D.S. edge	7,300mm
Rear wall to P.S. downstage edge	6,650mm
Maximum width	12,000mm
Depth below stage	2,250mm

### LOADING DOCK

#### Loading Door:

- located U.S. O.P.	
- ramp down to stage surface from door/street level	400mm
- max width	2130mm
- height of lower door	3006mm
- height of upper door	5400mm

#### Our Truck Ramp Dimensions

Length 5000mm
Width 1000mm
Edge height 50mm x 50mm

## OTHER EQUIPMENT

### PIANOS

1 x Black **Yamaha** 6 ' Conservatory Grand

### TREADS (2 SETS OF TWO UNITS)

**Set # 1** Treads from stage to auditorium  
900mm wide black painted plywood on aluminium  
Fit into corner of stage/auditorium. (no seats out)  
**Or** Fit into aisles (remove seats A18-19, A26-27)  
Pit cover / thrust must be at stalls or stage level

**Set # 2** 1200mm wide Megadeck treads from  
stage to Auditorium (some seats out), or on stage  
2 at 300, + 2 at 600 or 2 @ 900 high

Handrails available

### Mega Deck Risers

15 x 2400mm x 1200mm x 185mm  
Legs to finished heights; 300mm, 450mm, 600mm, 900mm

### LADDERS & ELEVATED WORK PLATFORMS

1 x 6.5m Upright MX-19 Elevated work platform  
1 x 10.0m Upright Airl Platform UL32  
1 x 0.9 m Fibreglass step ladder  
1 x 2.1m Fibreglass step/ ext. ladder  
1 x 2.4 m Fibreglass step ladder  
1 x 8.0 m Aluminium straight extension ladder

### CHAIRS

62 x Cloth / rust Banquet Style  
40 x Cloth / black Banquet Style

### BAR STOOLS

5 x Black with backrest  
6 x Black without backrest

### MUSIC STANDS

40 x Adjustable metal stands  
30 x Sconces  
2 x 20 circuit orchestra scone power loom

### TRESTLE TABLES

5 x Tables (2,400mm x 750mm)  
1 x Production Table & Bench (2400mm x 600mm)



