

Playhouse

A CIVIC PRECINCT NEWCASTLE VENUE

CIVIC THEATRE - CITY HALL - PLAYHOUSE - WHEELER PLACE - FORT SCRATCHLEY

375 HUNTER STREET NEWCASTLE NSW 2300 AUSTRALIA
TELEPHONE 02 4974 2166 admin@civictheatrenewcastle.com.au FACSIMILE 02 4974 2172

PLAYHOUSE

Technical Specification Information

	Page
Contents	1
Seating Plan / Capacity	2-3
Stage Plan	4-5
Stage Dimensions	6
Power / Dimmers	6
Lighting Control Desk / Equipment	7
Sound Desk / Equipment / Talkback	7
Stage Manager	8
Dressing Rooms	8
Miscellaneous	8
Lighting Truss	9
Standard Light Patch Sheet Prompt Side	10
Standard Light Patch Sheet OP Side	11
Load in Facilities	12

Playhouse Seating Plan

The total seating capacity for the Playhouse is 213 (not to scale)

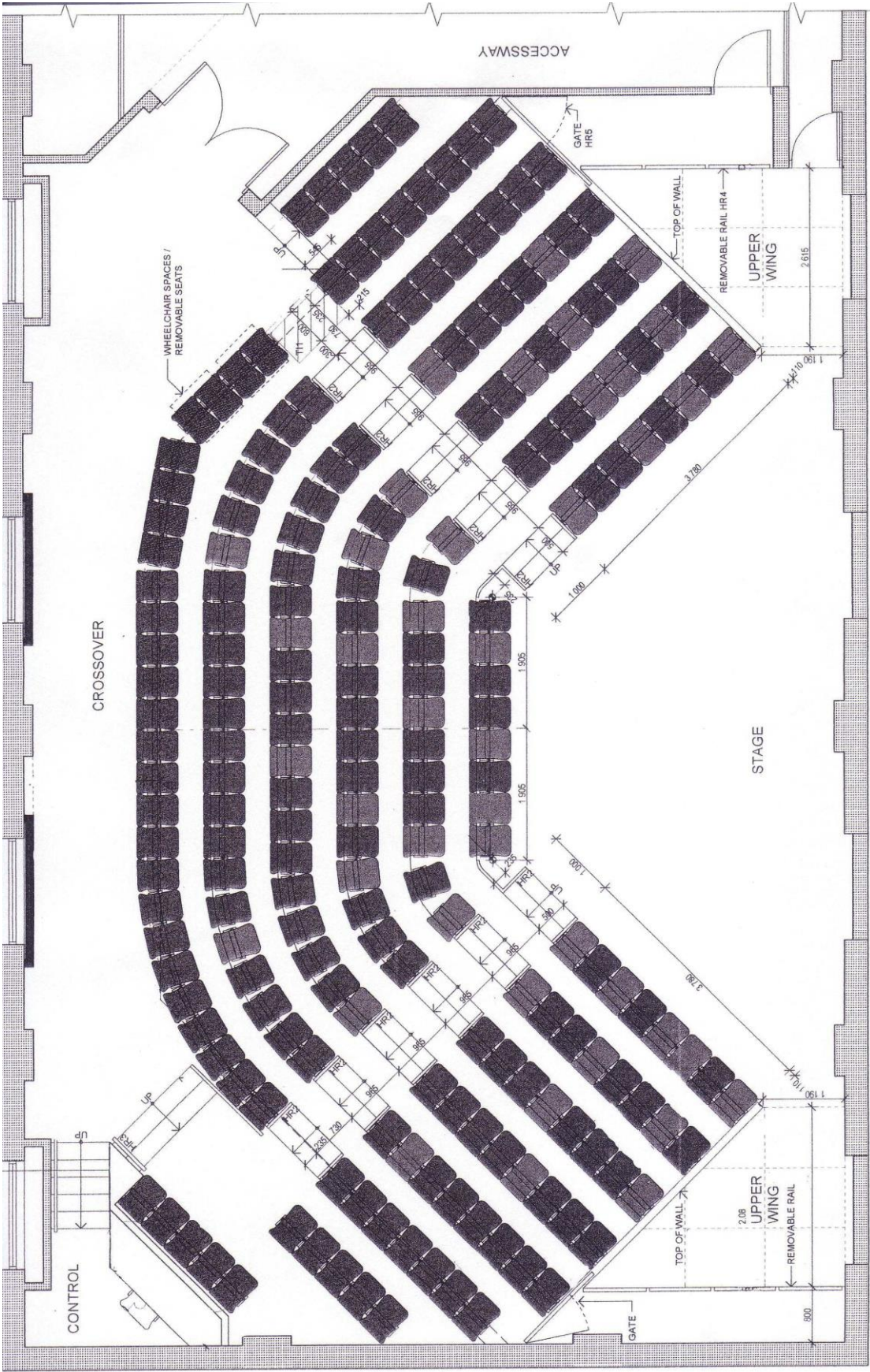

View of Auditorium from Stage



Stage Plan (1:50 scale)

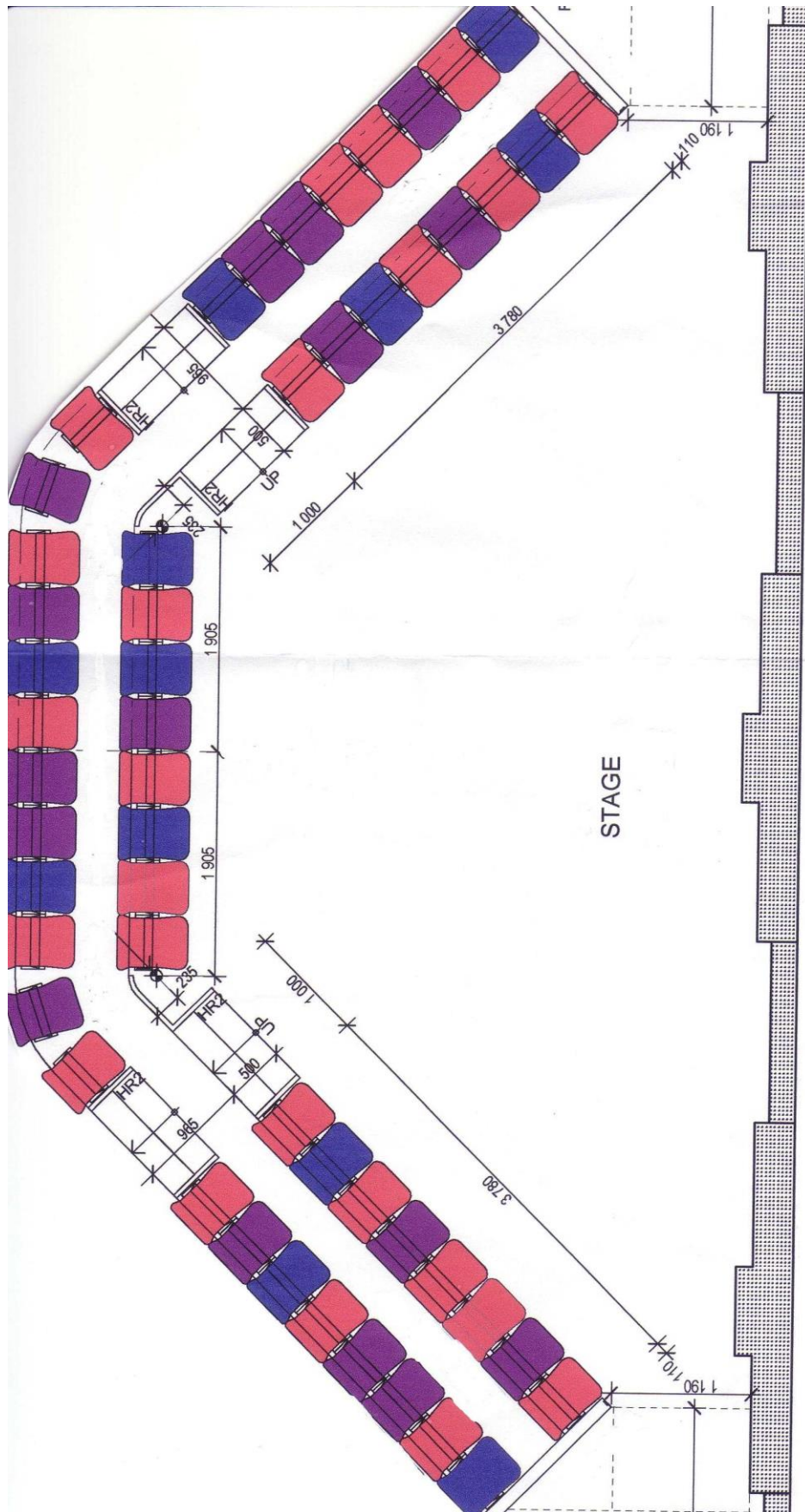



Stage Dimensions

Stage Area

Maximum Width DS	3800 mm
Maximum Width US (Loft to Loft)	10990 mm
Maximum Depth	4530 mm

Stage Heights

Stage Floor to underside of Lighting Grid	5100 mm
Stage Floor to underside of Profile on Lighting Grid	4500 mm
Stage Floor to underside of Lofts	2200 mm
Stage Floor to Loft Floor	2460 mm
Stage Floor to Cloth Truss	5000 mm

Loft Stage Area PS

Maximum Width DS	4600 mm
Maximum Width US	3400 mm
Maximum Depth	3500 mm
Minimum Depth	810 mm

Loft Stage Area OP

Maximum Width DS	4850 mm
Maximum Width US	2600 mm
Maximum Depth	3500 mm
Minim Depth	800 mm

Stage Surface

Flat floor on timber rafters

Finish is Tempered Masonite painted black

Maximum stage loading	Distributed 5.0KPA Concentrated 3.6 KPA
-----------------------	--

NOTE: There are no real wings other than the areas under the lofts. This space is used as access to and from stage via stairs.

Back Wall

Painted Plaster wall.

Rigging

There are 8 points above stage complete with 8 x 500kg Loadstar chain motors

WLL 300 kg per truss.

FOH Bars WLL 80kg ea.

Control is located OP wing. **Note: Operated by Permanent CPN Staff only!**

There are two tab tracks US.

Track 1 holds white Cyc.

Track 2 holds Swipe Action Black Tabs. Operated from PS wing.

Power / Dimmers

Power Supply

Main Power	160 amps
This supplies Stage Dimmers	

Road Power Hook Up

There is no extra power for touring hook-up

Lighting Control Desk / Equipment

Light Control Desk	ETC Ion console - 1024 channel
Riggers Control	N/A
Dimmers	4 x Bytecraft Solution 12 - Located in prompt corner Rack 1 - 12 x 2.4 dimmers - 25 thru 36 Rack 2 - 12 x 2.4 dimmers - 37 thru 48 Rack 3 - 12 x 2.4 dimmers - 49 thru 60 Rack 4 - 12 x 2.4 dimmers - 61 thru 72
Patch Outlets	Front of House 12 per side On Stage 12 on Floor Per On Stage Truss 30 Ea. (P & OP)
Lamp Stock	10 x ETC D60 LED 10 x ETC Source 4 LED 4 x Altman LED CYC - 200 10 x Strand Prelude 16-32 650 w Profiles 10 x Strand Cantata 1.2 k Fresnels 10 x Selecon 650w Fresnels (NO BARN DOORS)

Sound

Mixing Consoles	1 x Midas M32r 32 channel, 16 input, 8 mix outputs
System Processor	1 x Xilica XA-3060 - stereo in Meyer UPA-1P mono in Meyer UPM/UMS
Speakers	2 x Meyer UPA-1P (on lofts Stereo Main L&R) 3 x Meyer UPM-1P (Fixed to ceiling - Mono in) 1 x Meyer UMS-1P (Sub) 2 x Pastrong SPA 352 (Aux – F/B FX) 2 x Australian Monitor XDS10
Other Equipment	1 x Denon DN-T625 CD/ Tape player 1 x Sony CDP-XE500 CD player 4 x AKG D770 Mic 4 x Shure SM58 2 x LA Audio MK3 DI Box 2 x Beyerdynamic Lge Boom Stands 2 x Beyerdynamic Sml Boom Stands 6 x 10m Mic Lead 6 x 5m Mic Lead 9 x Patch Lead 2 x Speaker Lead
Talkback System	1 x Jands TB/M Master Station 3 x Jands TB/S Beltpack 3 x Beyerdynamic DT-109 Headset Patches in Bio, Wings, Dressing Room 1 x Page mic from Bio to Dressing room
Patching - Terminates in Bio	4 x XLR at DS PS 4 x XLR at DS Centre 4 x XLR at DS OP 2 x XLR at PS wing 12 in/6 return way stagebox to Bio 1 x Cat5 from Bio to DSC 2 x Cat5 From Bio to MDF Panel

Stage Manager / Dressing Rooms / Miscellaneous

Stage Manager

- Position located Prompt Wing
- Talkback to Bio Box
- Camera feed to Prompt side
- Programme Relay to Prompt side

Dressing Room # 1

- Seats approx. 8 persons
- Mirrors / counter / sink
- Dressing Room paging
- Toilets, Disabled, Male and Female
- Camera feed to Dressing Room
- Programme Relay to Dressing Room

Ladders

- 1 x Fibreglass A-Frame 8 foot
- 1 x Fibreglass A-Frame 4 Meters
- 1 x Fibreglass A-Frame (Offset for over chairs) 4 meters

Pianos

- 1 x 6ft Baby Conservatory Grand (C3)
- Yamaha tuned to A440
- 1 x Upright (U3) Yamaha tuned to A440

NB: Both pianos are located on a different floor level to the stage; therefore professional piano movers must be engaged at a cost of \$600 including GST to move the piano to the stage and back again. Added to this will be the cost of a tune. These costs will be charged on settlement.



Lighting Truss

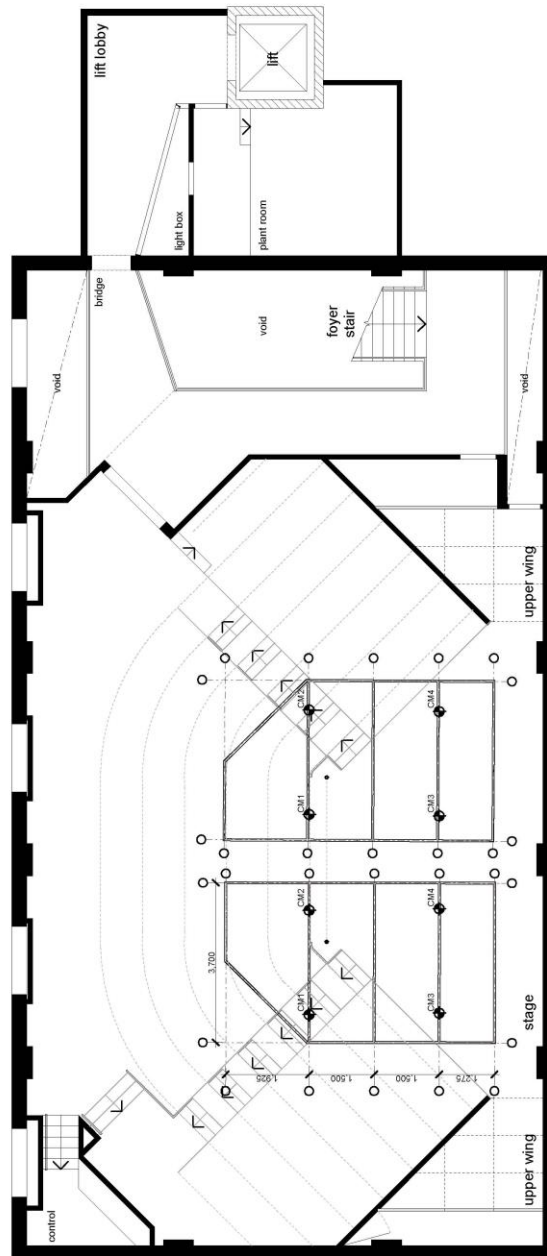

lighting truss



this drawing is for illustrative purposes only; measurements should be confirmed prior to commencement of any works

the information contained in this document is copyright and may not be used or reproduced for any other project or purpose

playhouse theatre
lighting truss
scale 1:100 @ A3

04 Playhouse

CIVIC PLAYHOUSE

Production: STD RIG PS

Lamp No.	Lamp Type	Loom	Patch	Address	Dimmer	Channel	Notes
Foh 1							
1	ETC Source 4 LED	Foh 1	1	103		3	
2		Foh 1	2				
3		Foh 1	3				
4		Foh 1	4				
5		Foh 1	5				
6	ETC Source 4 LED	Foh 1	6	88		2	
Foh 2							
1	ETC Source 4 LED	Foh 2	1	73		1	
2	Cantata 1.2k Fres	Foh 2	2		29	29	
3		Foh 2	3				
4		Foh 2	4				
5		Foh 2	5				
6	ETC D60	Foh 2	6	343		19	
LX 1							
1	ETC Source 4 LED	LX 1	1	178		8	
2	Prelude 650w Pro	LX 1	2		26	26	
3	Prelude 650w Pro	LX 1	3		25	25	
4		LX 1	4				
5		LX 1	5				
6	ETC Source 4 LED	LX 1	6	163		7	
LX 2							
1		LX 2	1				
2		LX 2	2				
3		LX 2	3				
4		LX 2	4				
5		LX 2	5				
6		LX 2	6				
LX 3							
1	ETC D60 LED	LX 3	1	238		12	
2		LX 3	2				
3		LX 3	3				
4		LX 3	4				
5		LX 3	5				
6	ETC D60 LED	LX 3	6	223		11	
LX 4							
1	Altman Cyc 200	LX 4	1	383		22	
2	Cantata 1.2k Fres	LX 4	2		30	30	
3		LX 4	3				
4		LX 4	4				
5		LX 4	5				
6	Altman Cyc 200	LX 4	6	373		21	
LX 5							
1	ETC D60 LED	LX 5	1	298		16	
2		LX 5	2				
3		LX 5	3				
4		LX 5	4				
5		LX 5	5				
6	ETC D60 LED	LX 5	6	283		15	

CIVIC PLAYHOUSE

Production: STD RIG OP

PLAYHOUSE: TECHNICAL SERVICES INVENTORY (PLEASE RETAIN)

Lamp No.	Lamp Type	Loom	Patch	Address	Dimmer	Channel	Notes
Foh 1							
1	ETC Source 4 LED	Foh 1	1	118		4	
2		Foh 1	2				
3		Foh 1	3				
4		Foh 1	4				
5		Foh 1	5				
6	ETC Source 4 LED	Foh 1	6	133		5	
Foh 2							
1	ETC Source 4 LED	Foh 2	1	148		6	
2	Cantata 1.2k Fres	Foh 2	2		31	31	
3		Foh 2	3				
4		Foh 2	4				
5		Foh 2	5				
6	ETC D60	Foh 2	6	358		20	
LX 1							
1	ETC Source 4 LED	LX 1	1	193		9	
2	Prelude 650w Pro	LX 1	2		27	27	
3	Prelude 650w Pro	LX 1	3		28	28	
4		LX 1	4				
5		LX 1	5				
6	ETC Source 4 LED	LX 1	6	208		10	
LX 2							
1		LX 2	1				
2		LX 2	2				
3		LX 2	3				
4		LX 2	4				
5		LX 2	5				
6		LX 2	6				
LX 3							
1	ETC D60 LED	LX 3	1	253		13	
2		LX 3	2				
3		LX 3	3				
4		LX 3	4				
5		LX 3	5				
6	ETC D60 LED	LX 3	6	268		14	
LX 4							
1	Altman Cyc 200	LX 4	1	393		23	
2	Cantata 1.2k Fres	LX 4	2		32	32	
3		LX 4	3				
4		LX 4	4				
5		LX 4	5				
6	Altman Cyc 200	LX 4	6	403		24	
LX 5							
1	ETC D60 LED	LX 5	1	313		17	
2		LX 5	2				
3		LX 5	3				
4		LX 5	4				
5		LX 5	5				
6	ETC D60 LED	LX 5	6	328		18	



LOADING FACILITIES

Stage / Loading Door

Located on Hunter Street

Stage is located one (1) floor up from street level

Maximum door access Height 2150 mm

Maximum door access Width 1100 mm

